

Subject Property

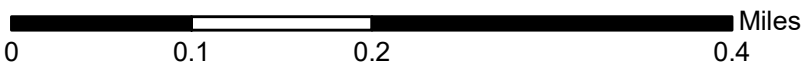

- Roads
- Property Boundaries

ZPH2021-00048
Pinners Cove Rezoning
Map Amendment





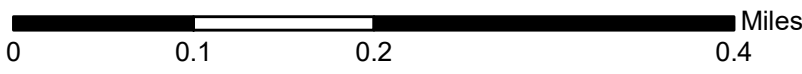
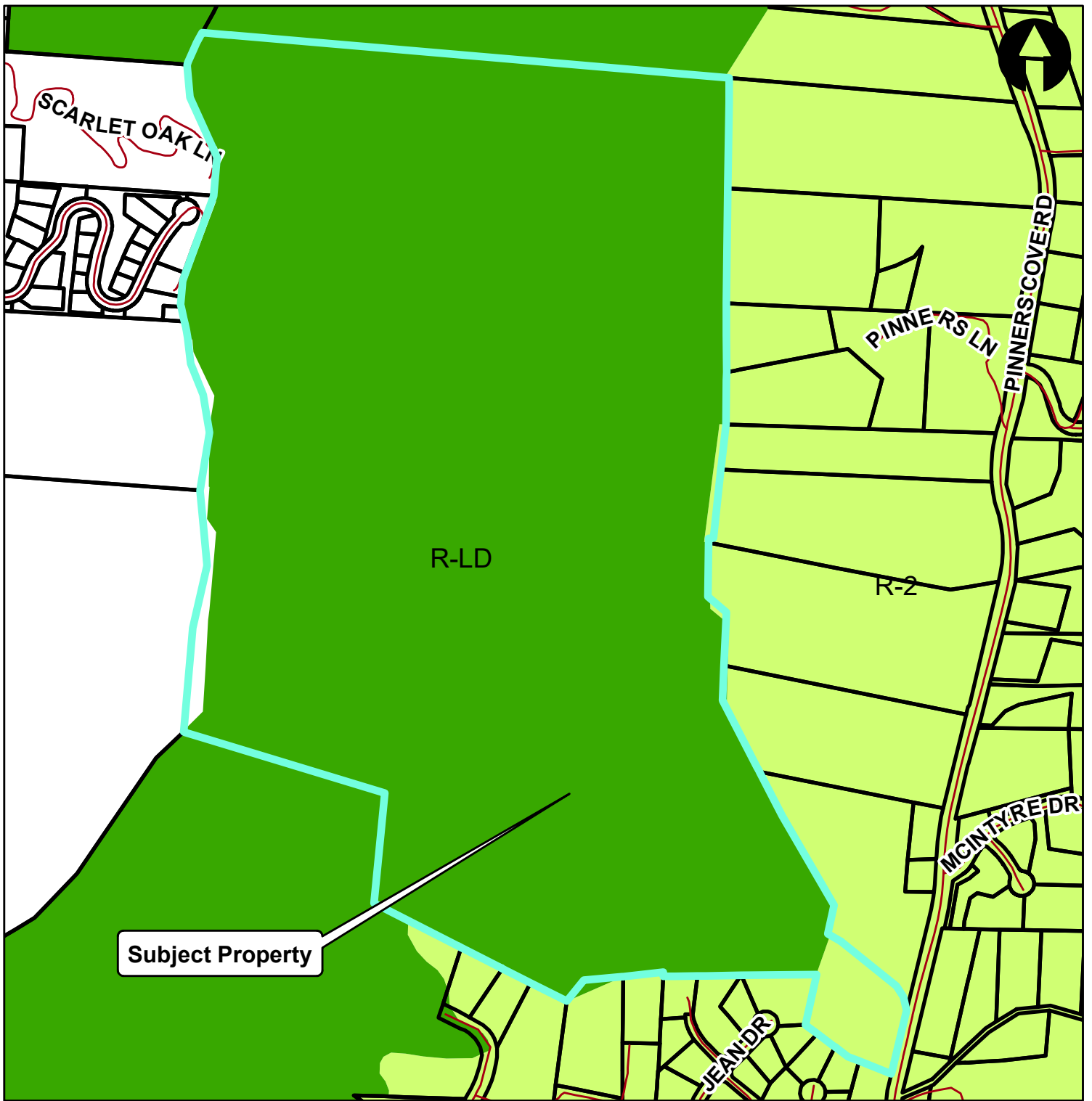



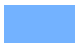

Aerial Map

Created By: Buncombe Co. Planning
 Date: 12/30/2021





ZPH2021-00048
Pinners Cove Rezoning
Map Amendment

Zoning Map

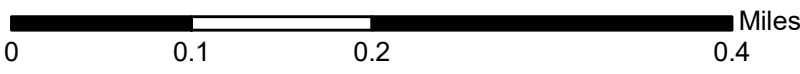
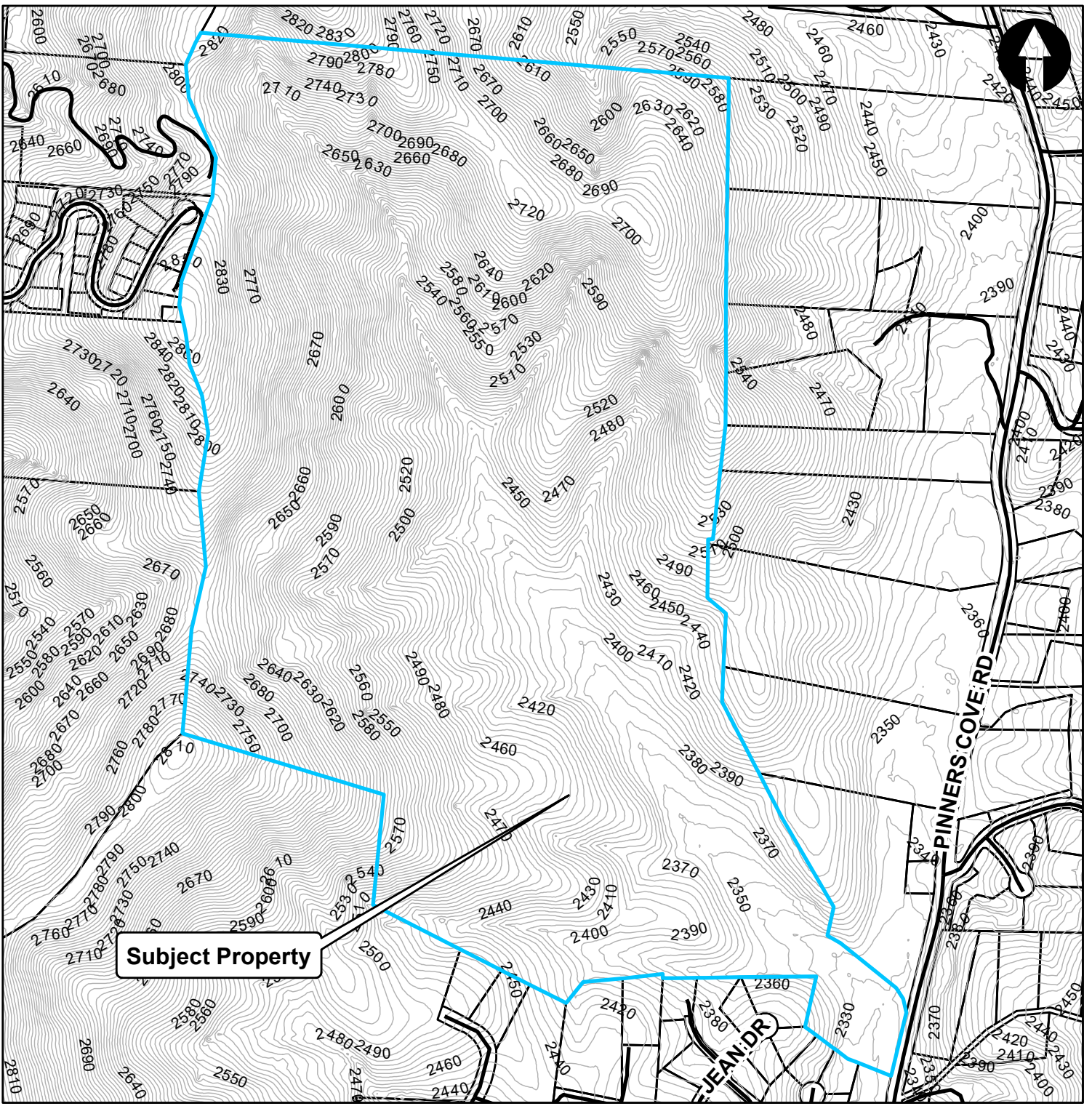
 AI	 EMP	 R-1
 BDM	 NS	 R-2
 CR	 OU	 R-3
 CS	 PS	 R-LD

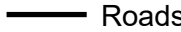

-  Roads
-  5 Foot Contours
-  Property Boundaries

ZPH2021-00048
Pinners Cove Rezoning
Map Amendment

Topo Map

Created By: Buncombe Co. Planning
 Date: 12/30/2021

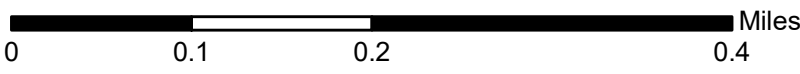
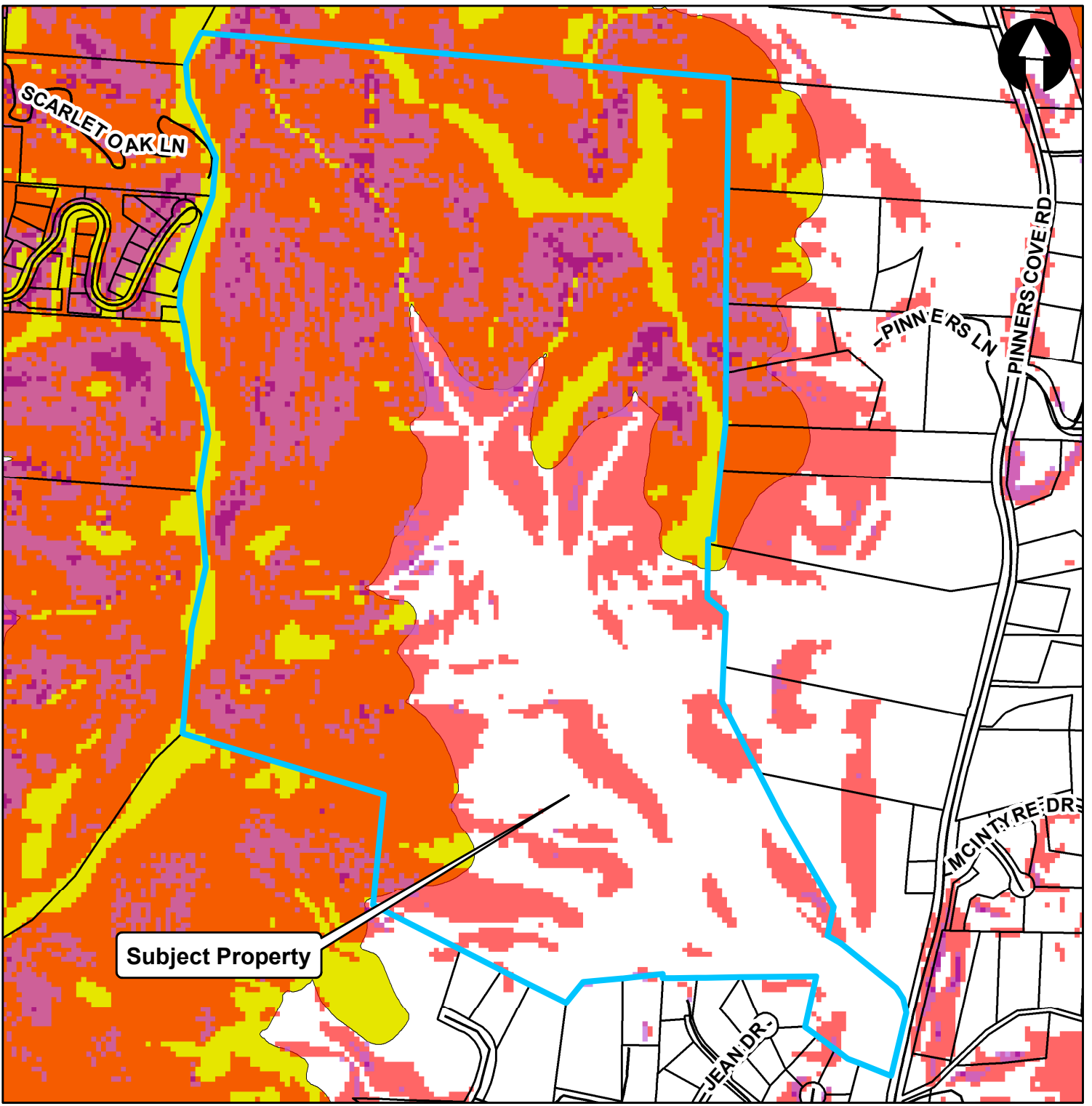

ZPH2021-00048
Pinner's Cove Rezoning
Map Amendment

Land Use Map

Created By: Buncombe Co. Planning
 Date: 12/30/2021

- | | |
|-----------------|-------------------------------|
| 500 yr | 0 - 25 % Slope |
| A - 100yr | Greater than 25% Slope |
| AE - 100 yr | Greater than 2500' |
| High Hazard | Proximity to Public Utilities |
| Moderate Hazard | Transportation Corridors |
| Low Hazard | |