



Request for Reallocation of FY23 Budget Item

Presented by

Robert Brown

General Services



FY23 Capital Project

| Department | Project | Amount | Funding Source |
|--------------------|--------------------------------------|-------------|----------------|
| Emergency Services | Emergency Services Base Construction | \$7,250,000 | Debt |



Proposed Reallocation of Funds

Establish a new capital project to explore potential siting and construction of a EMS Base in West Asheville. The project will initially consist of the following scope:

1. Conducting a feasibility study of the 4.77-acre Asheville Primary School site to determine the best use opportunities for the site to accommodate both Asheville City Schools and Buncombe County.
2. Placement of a temporary mobile EMS base on the Asheville Primary School site.

The total cost of this project is \$650,000, including \$150,000 for the feasibility study and \$500,000 for the temporary EMS base. General Services requests to reallocate \$650,000 from the existing FY23 EMS Base Construction project in order to fund this project, which would reduce the FY23 EMS Base Construction project budget from \$7,250,000 to \$6,600,000. No new County funding is required.

In addition, General Services requests to amend the scope of the FY23 EMS Base Construction project to be for the construction of a permanent EMS Eastern Base to be located near Owen Pool



Linkage to EMS Study

The EMS study prioritizes 5 areas to improve service and response times. Three of those areas will be improved with the addition of the McCormick station, leaving West Asheville and the Swannanoa/Black Mtn area in need of new stations.

Status of Priority EMS Bases

| Base Location | EMS Study notes | Project Status |
|----------------------------|--|---|
| South Asheville | Impacted by addition of McCormick EMS Station | 40 McCormick designer selected |
| Downtown | Impacted by addition of McCormick EMS Station | 40 McCormick designer selected |
| West Asheville | | Temp base planned to expedite service while final location is determined through the Asheville Primary Study. |
| Skyland/Southern Asheville | Impacted by addition of new ambulance nearby and McCormick EMS Station | 40 McCormick designer selected |
| Swannanoa/Black Mtn | | Swannanoa property at Owen Pool is available |

Asheville Primary School Possible Location



Temporary EMS Base

The area shown is tentative relative to what the Asheville Primary School Feasibility Study Determines.



Temporary Mobile Modular EMS Office concept with office area converted to sleeping quarters.

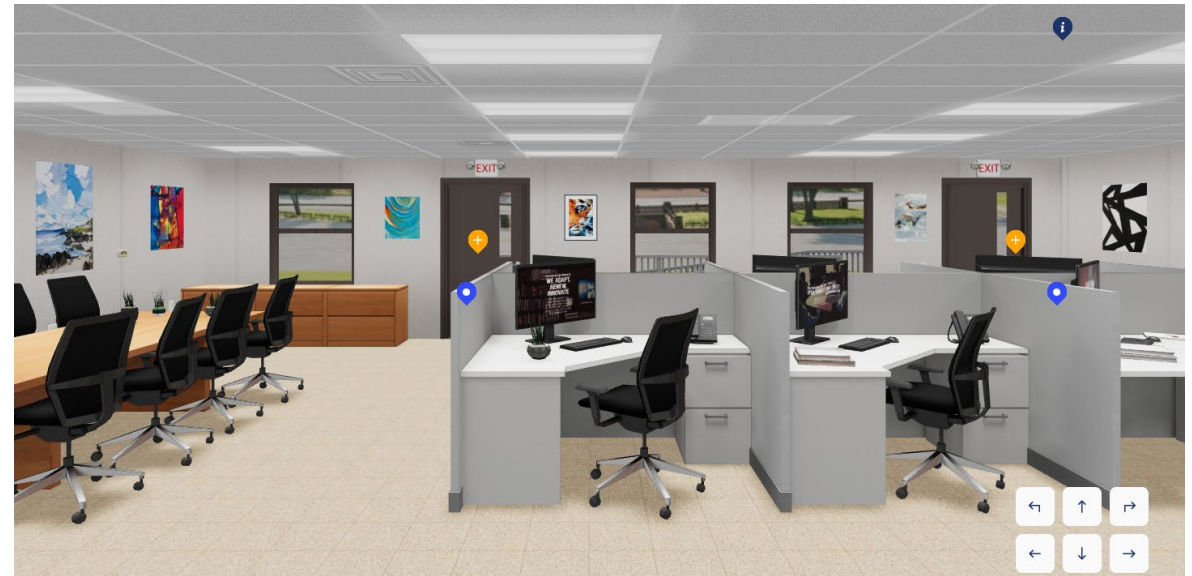
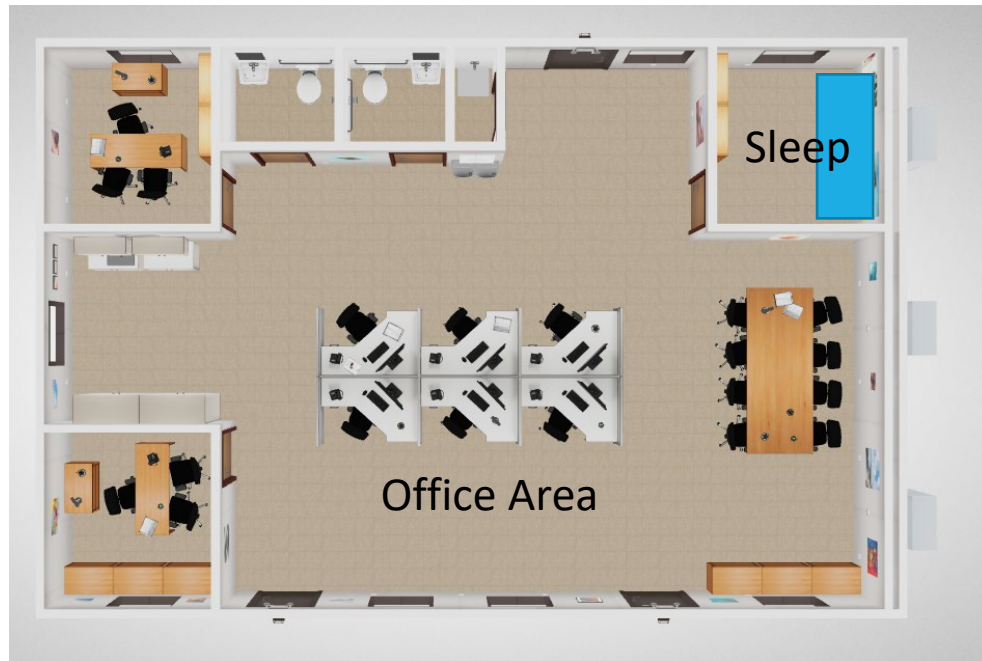

Exact number of workstations and sleeping areas are to be determined.



**Pre- Engineered Metal 2 Bay EMS Vehicle Storage
Concept Building will be able to be unassembled
and reassembled at an alternate location.**



Owen Pool Property Proposed Location



Permanent EMS Eastern Base

The area shown is the area intended for use for the construction of the building, drives, parking, and generator. Planned to meet LEED Adopted Resolution.



Next Steps

Reallocate \$650,000 from the existing FY23 EMS Base Construction project in order to fund the Asheville Primary School site feasibility study and the installation of a temporary mobile EMS base at the Asheville Primary School site; which would reduce the FY23 EMS Base Construction project budget from \$7,250,000 to \$6,600,000. No new County funding is required.

In addition, amend the scope of the FY23 EMS Base Construction project to be for the construction of a permanent EMS Eastern Base to be located near Owen Pool.



Questions

