



Mikayla Beysher <mikayla.beysher@bcsemail.org>

Here's Your Custom Design and Estimate! (#1595941911748625)

5 messages

Express Carport <expresscarport@gmail.com>
To: mikayla.beysher@bcsemail.org

Tue, Jul 28, 2020 at 9:11 AM



Congratulations on designing your building! Our goal is to exceed your expectations of our service and product. If you have immediate questions or concerns, please contact us.

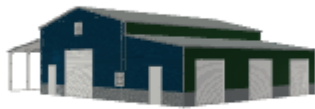

17' 6"

10'

~17' 6"

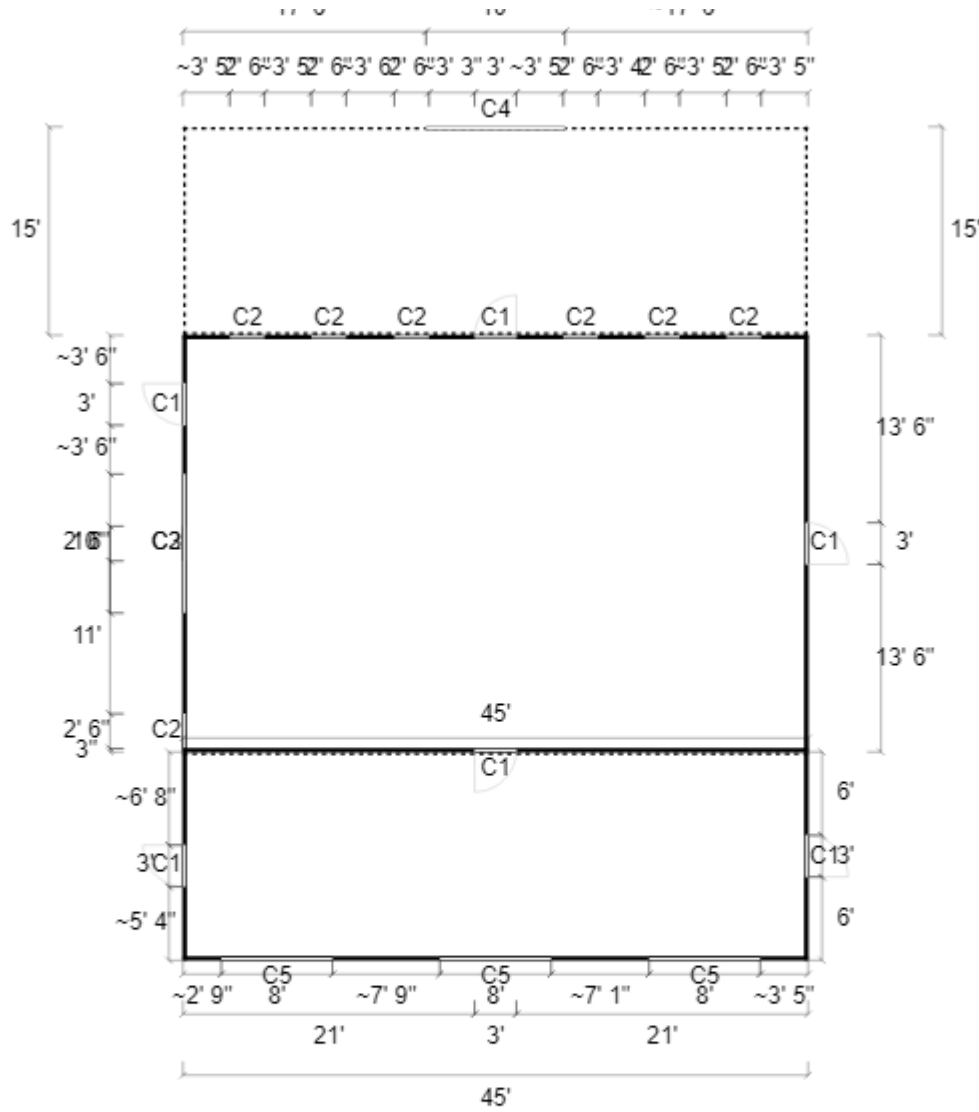

Symbol Legend:

- C1: Walk-in Door (36x80)
- C2: 30W x 30H Windows
- C3: 10x10
- C4: Custom Size (1' to 12' Wide)
- C5: 8x8

[Open Your Custom Design](#)

Customer Contact Information

Name: Mikayla Beysher
 Email: mikayla.beysher@bcsemail.org
 Phone: 8282086853

Dealer Information

Sales Rep Name: Mark

Delivery Information

Delivery Location: A Plus Price Book
 Delivery Address: [475 Enka Lake Road](#)
 Delivery City: Candler
 Delivery State: NC
 Delivery ZIP: 28715

Additional Comments

Notes, Comments, Questions: Update after barn meeting

The information below is an estimate only. Final pricing - including pricing adjustments, discounts, delivery, and taxes - will be provided with final quote prior to purchase.

Estimate: \$38,790.00

Deposit Amount (15%): \$5,818.50
 Due Upon Delivery: \$32,971.50

24 Month Rent to Own Payment (plus tax)	\$2,586.00
36 Month Rent to Own Payment (plus tax)	\$1,959.09
48 Month Rent to Own Payment (plus tax)	\$1,795.83
60 Month Rent to Own Payment (plus tax)	\$1,686.52

Structure Details

Style: Step Down Barn	-
Roof: Gray	-
Trim: Gray	-
Gableend: Gallery	\$100.00
Sidewall: Forest	\$100.00

Waincot: Gray	-
Base Price: 30'x46'	\$6,210.00
None Storage Depth: 5'	-
Roof Style: Vertical Roof	-
Roof Overhang: 6"	-
Leg Style: Ladder Legs	-
Gauge: 14-Gauge Framing	-
Brace: Standard Brace	-
Engineer Certified: Certify Building	\$1,000.00
Leg Height: 15'	\$3,100.00
Left Side: Fully Enclosed	\$1,135.00
Left Side Siding: Horizontal	-
Right Side: Fully Enclosed	\$1,135.00
Right Side Siding: Horizontal	-
Front End: Fully Enclosed	\$2,500.00
Front End Siding: Horizontal	-
Back End: Fully Enclosed	\$2,500.00
Back End Siding: Horizontal	-
Trusses: Triple Wide	-
Insulation Insulation: Roof	\$1,440.00
Insulation Insulation: Left Sidewall	\$675.00
Insulation Insulation: Right Sidewall	\$675.00
Insulation Insulation: Back Wall	\$510.00
Insulation Insulation: Front Wall	\$510.00
Left Lean ^{SEP} Base Price: 15'x46'	\$2,990.00
Left Lean ^{SEP} Type: Lean only	-
Left Lean ^{SEP} Leg Style: Ladder Legs	-
Left Lean ^{SEP} Gauge: 14-Gauge Framing	-
Left Lean ^{SEP} Brace: Standard Brace	-
Left Lean ^{SEP} Engineer Certified: Certify Building	\$500.00
Left Lean ^{SEP} Leg Height: 10'	\$480.00
Left Lean ^{SEP} Insulation Insulation: Roof	\$765.00
Left Lean ^{SEP} Connection Fee Side to Side	\$100.00
Right Lean Waincot: Gray	-
Right Lean Base Price: 15'x46'	\$2,990.00
Right Lean Type: Lean only	-
Right Lean Leg Style: Ladder Legs	-

Right Lean Gauge: 14-Gauge Framing	-
Right Lean Brace: Standard Brace	-
Right Lean Engineer Certified: Certify Building	\$500.00
Right Lean Leg Height: 10'	\$480.00
Right Lean Right Side: Fully Enclosed	\$610.00
Right Lean Right Side Siding: Horizontal	-
Right Lean Front End: Fully Enclosed	\$730.00
Right Lean Front End Siding: Horizontal	-
Right Lean Back End: Fully Enclosed	\$730.00
Right Lean Back End Siding: Horizontal	-
Right Lean Insulation Insulation: Roof	\$765.00
Right Lean Insulation Insulation: Right Sidewall	\$450.00
Right Lean Insulation Insulation: Back Wall	\$180.00
Right Lean Insulation Insulation: Front Wall	\$180.00
Right Lean Connection Fee Side to Side	\$100.00

Roll Doors & Ramps

10x10	\$500.00
Right Lean 8x8	\$350.00
Right Lean 8x8	\$350.00
Right Lean 8x8	\$350.00

Doors & Ramps

Walk-in Door (36x80)	\$250.00
Walk-in Door (36x80)	\$250.00
Walk-in Door (36x80)	\$250.00
Walk-in Door (36x80)	\$250.00
Right Lean Walk-in Door (36x80)	\$250.00
Right Lean Walk-in Door (36x80)	\$250.00

Windows & Accessories

30W x 30H Windows	\$150.00
30W x 30H Windows	\$150.00
30W x 30H Windows	\$150.00
30W x 30H Windows	\$150.00
30W x 30H Windows	\$150.00
30W x 30H Windows	\$150.00
30W x 30H Windows	\$150.00
30W x 30H Windows	\$150.00

Frameouts

Corner Style: Square (Traditional)	-
Left Lean ^[SEP] Custom Size (1' to 12' Wide) (10'x10')	\$100.00
Left Lean ^[SEP] Corner Style: Square (Traditional)	-
Right Lean Corner Style: Square (Traditional)	-
Right Lean Corner Style: Square (Traditional)	-
Right Lean Corner Style: Square (Traditional)	-

Additions and Adjustments

* Customer Must Provide Telescopic Lift -

Additional Fees

Right Lean Garage Door Header Bar	\$100.00
Right Lean Garage Door Header Bar	\$100.00
Right Lean Garage Door Header Bar	\$100.00

Pricing and options shown are subject to change at any time and may vary based upon current promotions, specials, or annual pricing adjustments. Current pricing will be included in the final quote and will require your review and approval prior to order.

We will do all we can to ensure your complete satisfaction. Please contact your local dealer or rep for questions, concerns, or custom styles or sizes.

Mikayla Beysher <mikayla.beysher@bcsemail.org>
To: expresscarports@gmail.com

Fri, Jul 31, 2020 at 10:49 AM

[Quoted text hidden]

Mail Delivery Subsystem <mailer-daemon@googlemail.com>
To: mikayla.beysher@bcsemail.org

Fri, Jul 31, 2020 at 10:49 AM



Address not found

Your message wasn't delivered to
expresscarports@gmail.com because the address couldn't be

found, or is unable to receive mail.

[LEARN MORE](#)

The response was:

550 5.1.1 The email account that you tried to reach does not exist. Please try double-checking the recipient's email address for typos or unnecessary spaces. Learn more at <https://support.google.com/mail/?p=NoSuchUser> a5sor4949910wmm.0 - gsmtpt

Final-Recipient: rfc822; expresscarports@gmail.com

Action: failed

Status: 5.1.1

Diagnostic-Code: smtp; 550-5.1.1 The email account that you tried to reach does not exist. Please try

550-5.1.1 double-checking the recipient's email address for typos or

550-5.1.1 unnecessary spaces. Learn more at

550 5.1.1 <https://support.google.com/mail/?p=NoSuchUser> a5sor4949910wmm.0 - gsmtpt

Last-Attempt-Date: Fri, 31 Jul 2020 07:49:48 -0700 (PDT)

----- Forwarded message -----

From: Mikayla Beysher <mikayla.beysher@bcsemail.org>

To: expresscarports@gmail.com

Cc:

Bcc:

Date: Fri, 31 Jul 2020 10:49:37 -0400

Subject: Fwd: Here's Your Custom Design and Estimate! (#1595941911748625)

----- Message truncated -----

Mikayla Beysher <mikayla.beysher@bcsemail.org>
To: expresscarport@gmail.com

Fri, Jul 31, 2020 at 10:50 AM

[Quoted text hidden]

Mikayla Beysher <mikayla.beysher@bcsemail.org>
To: "danielbeysher@gmail.com" <danielbeysher@gmail.com>

Tue, Aug 4, 2020 at 10:34 AM

8/25/2020

Buncombe County Schools Mail - Here's Your Custom Design and Estimate! (#1595941911748625)

----- Forwarded message -----

From: **Express Carport** <expresscarport@gmail.com>

Date: Tue, Jul 28, 2020 at 9:12 AM

Subject: Here's Your Custom Design and Estimate! (#1595941911748625)

To: <mikayla.beysheer@bcsemail.org>

[Quoted text hidden]