

# Former Weaverville ETJ, Various Applicants Map 1: Topography

Requested Zoning:

- Commercial Service District CS

Current Zoning:

- Residential District R-3

Staff Recommendation:

- Approval

Planning Board

Recommendation:

- Approval

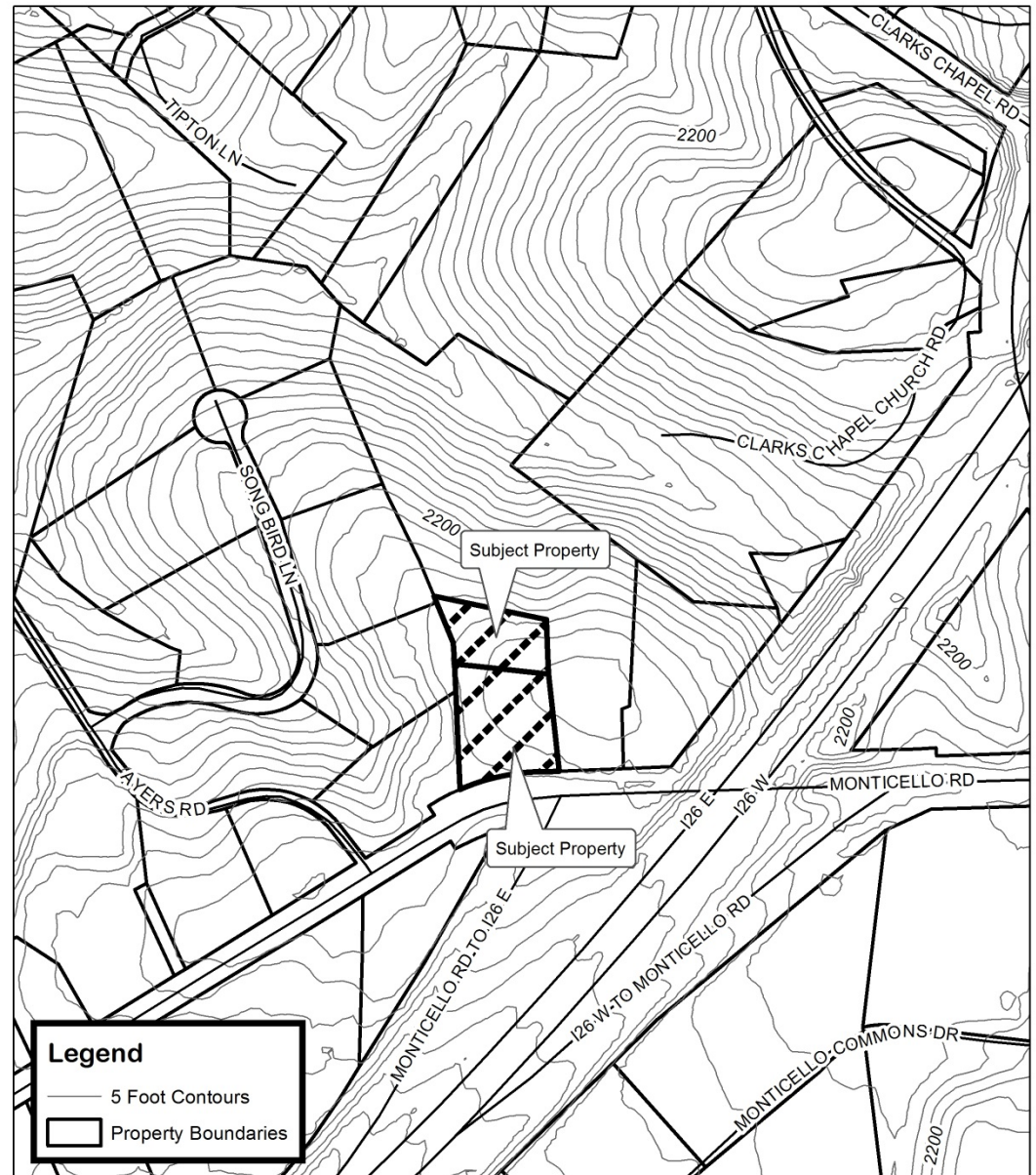

## Songbird Development Group, LLC Map Amendment

Case Number: ZPH2014-00079

Approximate Property Size: 1.45 acres

Application Date: December 15, 2014

Planning Board Hearing Date: January 26, 2015



Created By: Buncombe County Planning  
Date: February 16, 2015

# Former Weaverville ETJ, Various Applicants

## Map 2: Aerial Photo

Requested Zoning:

- Commercial Service District CS

Current Zoning:

- Residential District R-3

Staff Recommendation:

- Approval

Planning Board

Recommendation:

- Approval



### Songbird Development Group, LLC Map Amendment

Case Number: ZPH2014-00079

Approximate Property Size: 1.45 acres

Application Date: December 15, 2014

Planning Board Hearing Date: January 26, 2015



0 100 200 400  
Feet

Created By: Buncombe County Planning  
Date: February 16, 2015

# Former Weaverville ETJ, Various Applicants

## Map 3: Land Use Constraints

### Requested Zoning:

- Commercial Service District CS

### Current Zoning:

- Residential District R-3

### Staff Recommendation:

- Approval

### Planning Board

### Recommendation:

- Approval

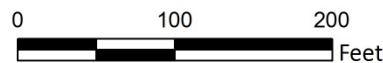
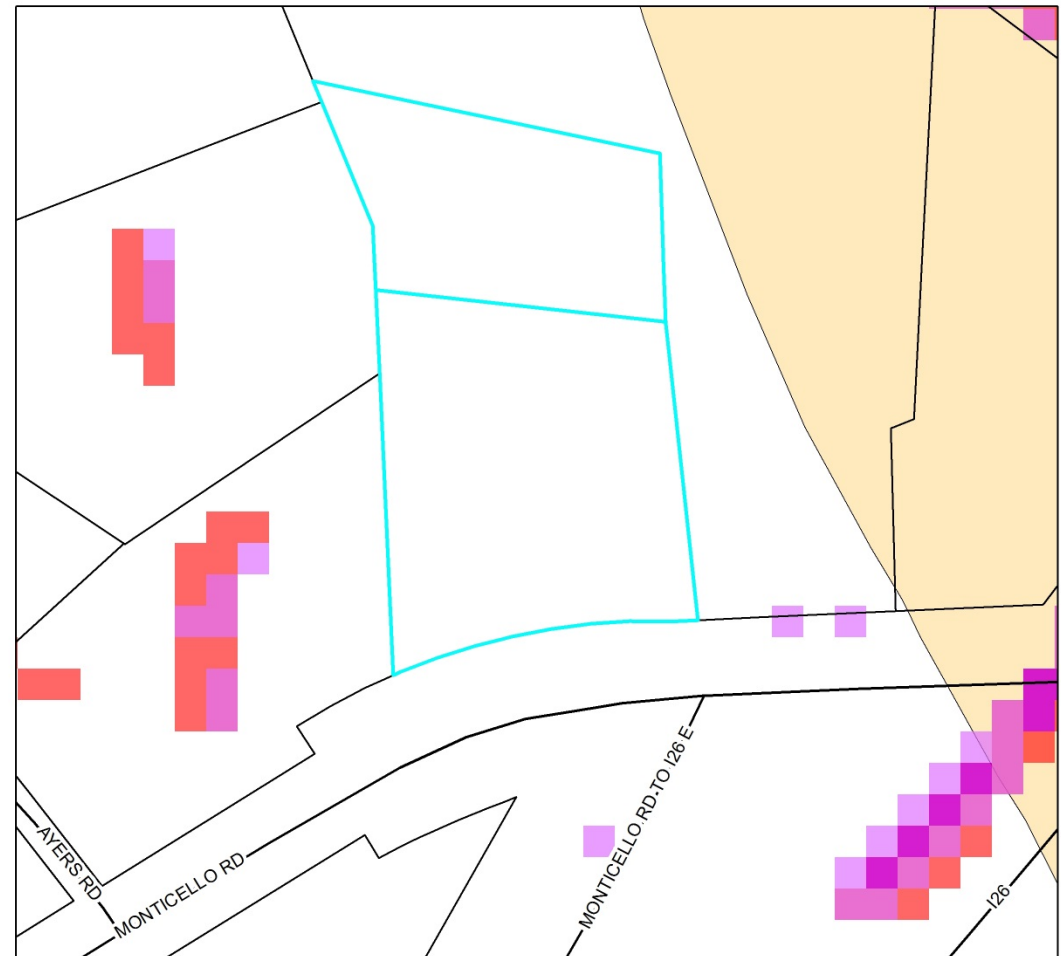

### Songbird Development Group, LLC Map Amendment

Case Number: ZPH2014-00079  
 Approximate Property Size: 1.45 acres  
 Application Date: December 15, 2014  
 Planning Board Hearing Date: January 26, 2015

Created By: Buncombe County Planning  
 Date: February 16, 2015

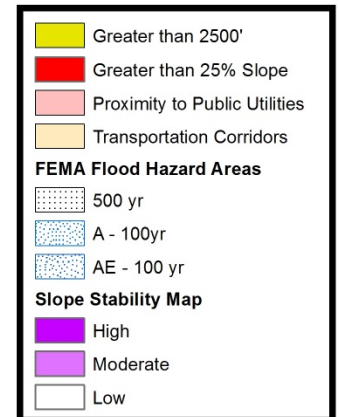

# Former Weaverville ETJ, Various Applicants Map 4: Zoning

Requested Zoning:

- Commercial Service District CS

Current Zoning:

- Residential District R-3

Staff Recommendation:

- Approval

Planning Board

Recommendation:

- Approval

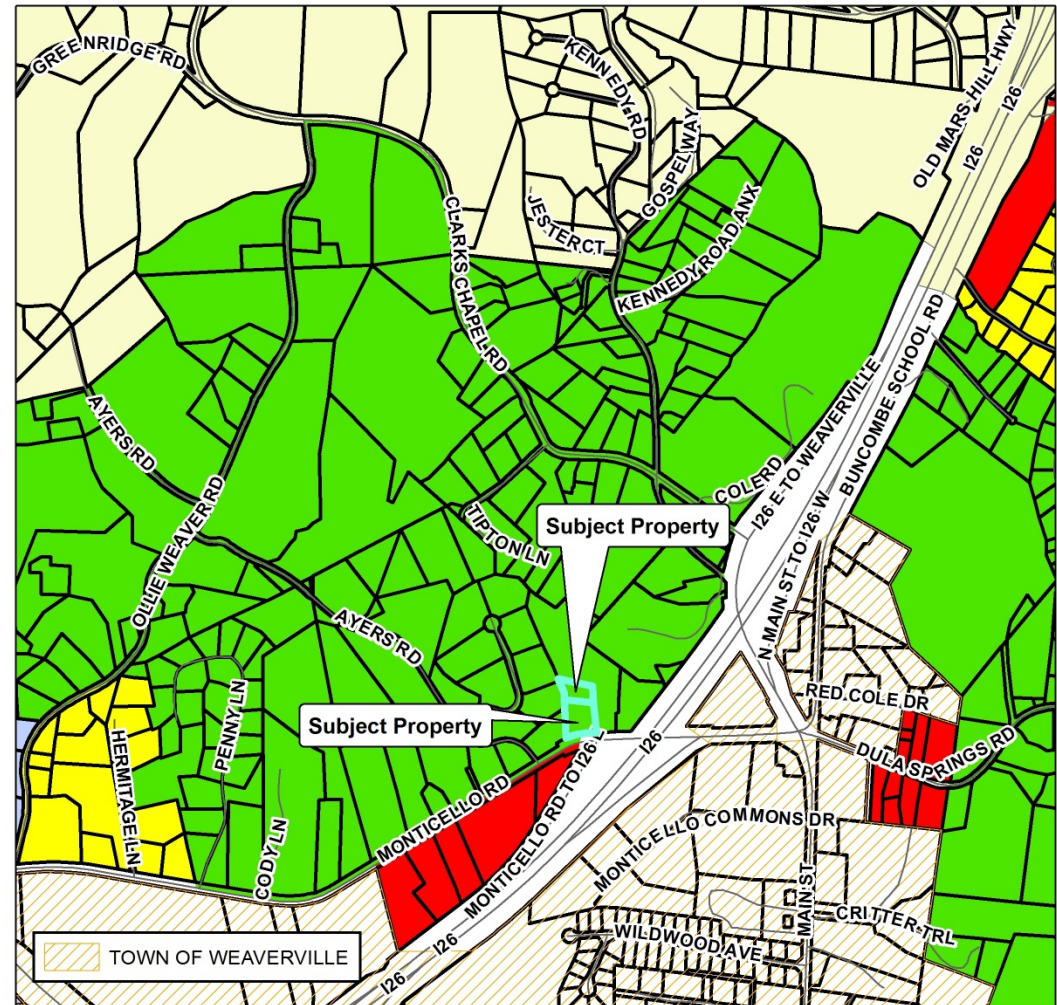

## Songbird Development Group, LLC Map Amendment

Case Number: ZPH2014-00079  
 Approximate Property Size: 1.45 acres  
 Application Date: December 15, 2014  
 Planning Board Hearing Date: January 26, 2015

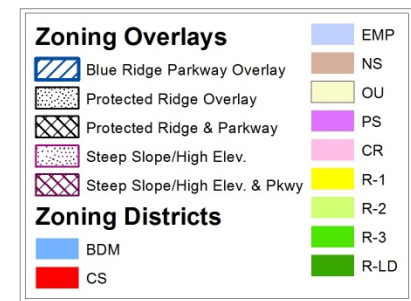

Created By: Buncombe County Planning  
 Date: February 16, 2015