

Nelson Allison

Map 1: Topography

Requested Zoning:

- Residential District R-3

Current Zoning:

- Single-Family Residential R-1

Staff Recommendation:

- Denial

Planning Board

Recommendation:

- Denial

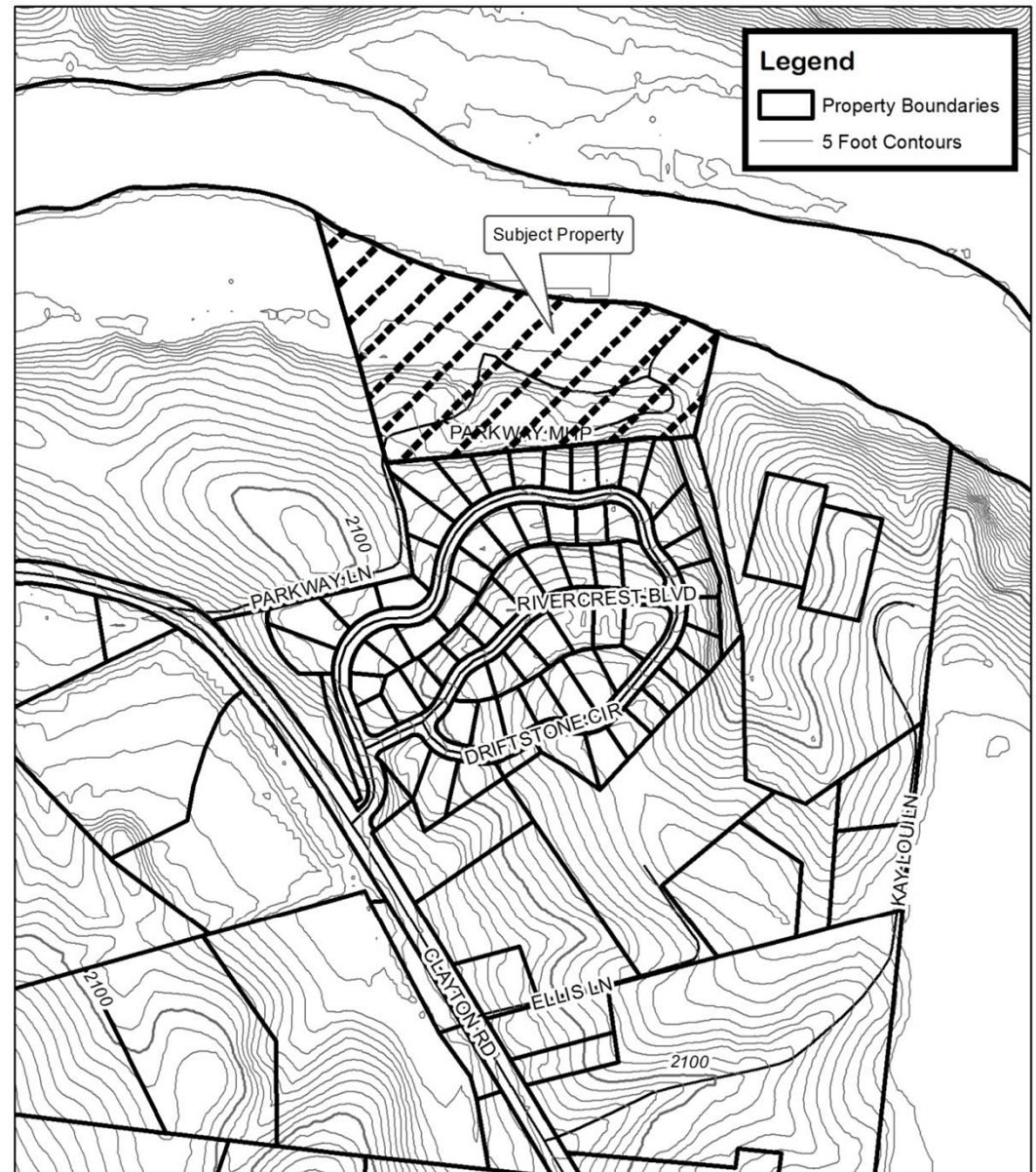

Nelson B. Allison Map Amendment

Case Number: ZPH2013-00053

Approximate Property Size: 8.64 acres

Application Date: November 21, 2013

Planning Board Hearing Date: January 6, 2014

Created By: Buncombe County Planning
Date: December 10, 2013

Nelson Allison

Map 2: Aerial Photo

Requested Zoning:

- Residential District R-3

Current Zoning:

- Single-Family Residential R-1

Staff Recommendation:

- Denial

Planning Board

Recommendation:

- Denial



Nelson B. Allison Map Amendment

Case Number: ZPH2013-00053

Approximate Property Size: 8.64 acres

Application Date: November 21, 2013

Planning Board Hearing Date: January 6, 2014



0 200 400 800
Feet

Created By: Buncombe County Planning
Date: December 10, 2013

Nelson Allison

Map 3: Land Use Constraints

Requested Zoning:

- Residential District R-3

Current Zoning:

- Single-Family Residential R-1

Staff Recommendation:

- Denial

Planning Board

Recommendation:

- Denial

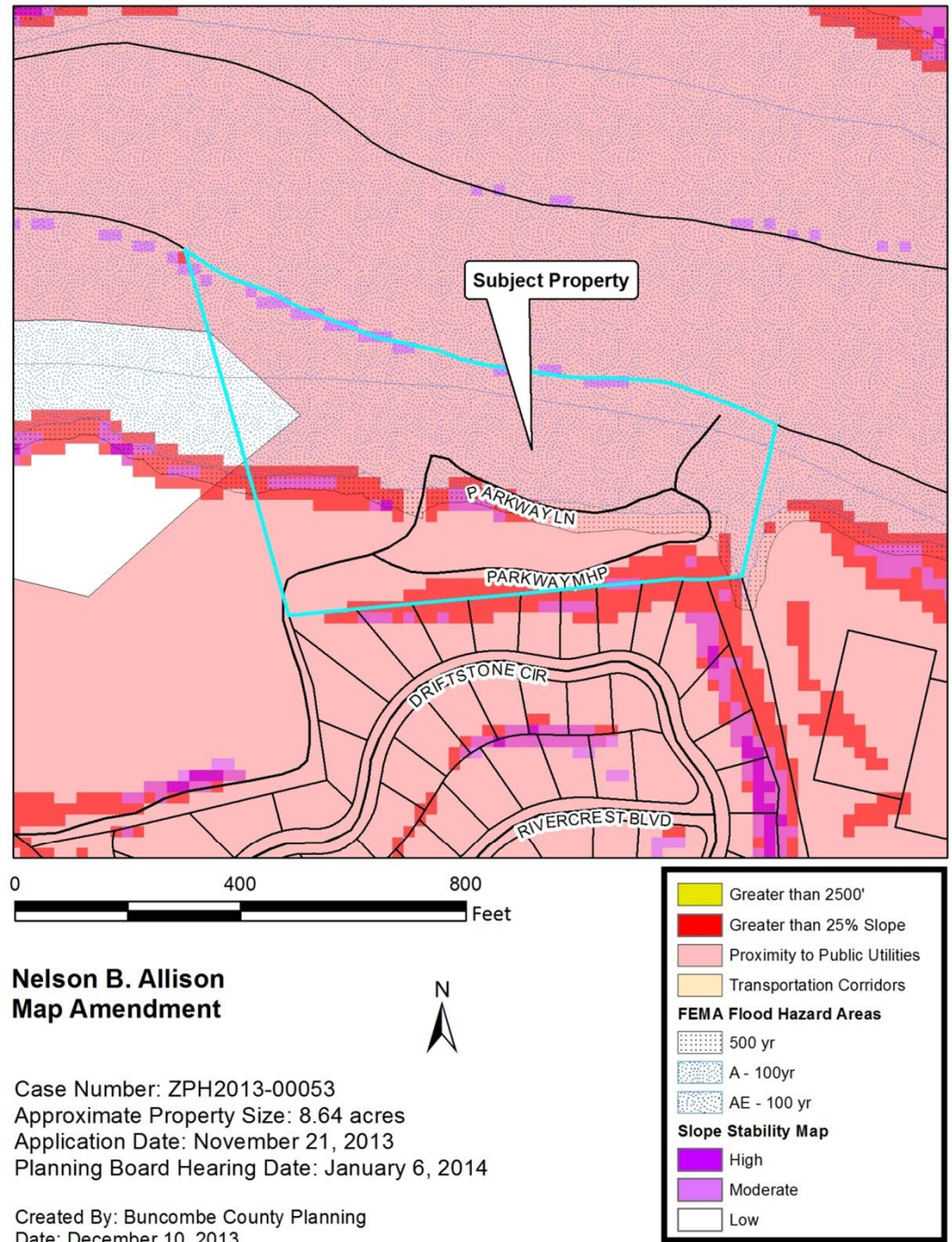

Nelson Allison

Map 4: Zoning

Requested Zoning:

- Residential District R-3

Current Zoning:

- Single-Family Residential R-1

Staff Recommendation:

- Denial

Planning Board

Recommendation:

- Denial

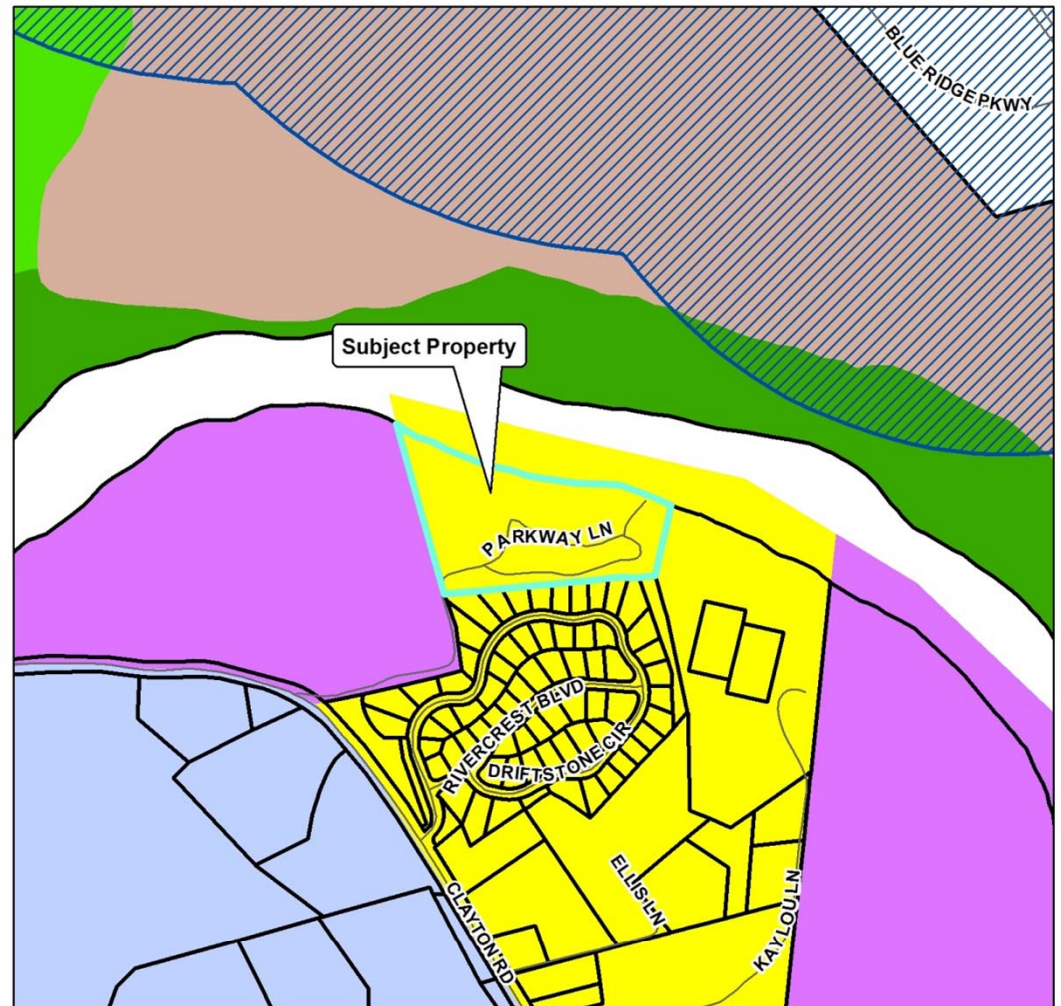

**Nelson B. Allison
Map Amendment**

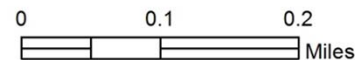

Zoning Districts		Zoning Overlays	
BDM	R-1	Blue Ridge Parkway Overlay	Protected Ridge Overlay
CS	R-2	Protected Ridge & Parkway	Steep Slope/High Elev.
EMP	R-3	Steep Slope/High Elev. & Pkwy	
NS	R-LD		
OU			

Case Number: ZPH2013-00053
Approximate Property Size: 8.64 acres
Application Date: November 21, 2013
Planning Board Hearing Date: January 6, 2014



Created By: Buncombe County Planning
Date: December 10, 2013